

1 2 3 4 5 6 7 8

A

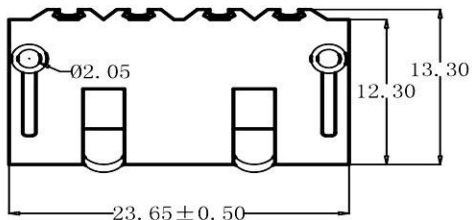

B

C

D

E

F

G

H

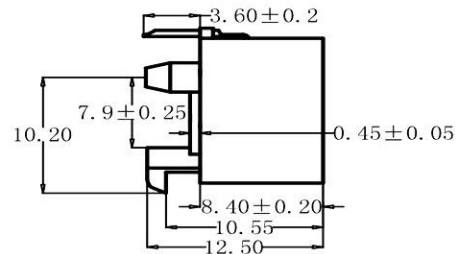

Specifications:

- Material:  
Bass: Nylon 66 UL 94V-2  
Contact: Brass, Tin-Plated
- Voltage Rating: 250V
- Current Rating: 7A
- Withstand Voltage: 1500V AC/Minute
- Insulation Resistance: 1000MΩ min.
- Temperature Range: -25°C~+85°C
- Contact Resistance: Initial value/10mΩ max.

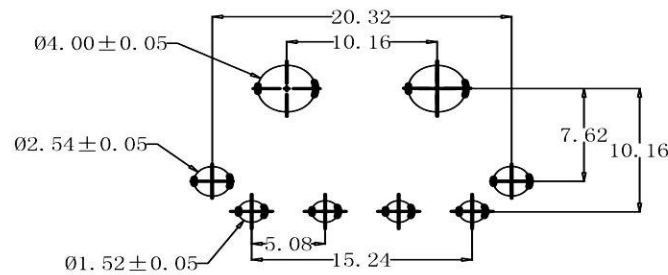
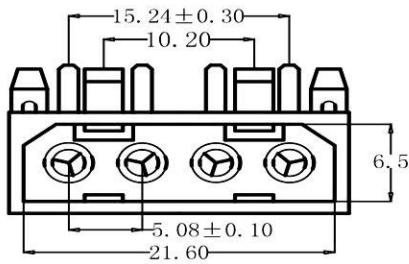

P.C.B LAYOUT

RoHS Compliant		<b>HSM</b> 玄茂科技股份有限公司 HSUAN MAO TECHNOLOGY CO., LTD.	
APPD. 核准 HELEN	 TOLERANCE 零件公差 0 ± 0.25 0.00 ± ANG ±	PART NAME 品名 5.08mm POWER PLUG 4P RIGHT ANGLE TYPE TIN PLATED WHITE COLOR ROHS	
DWG. 製圖 ABBY	SCALE 比例 參考	UNIT 單位 MM	SIZE 紙張尺寸 A4
DATE 制表日 2014/05/12	PAGE 張數 1 OF 1	REV. 版本 A	PART NO. 料號 W2470-04PRTW10R

1 2 3 4 5 6 7 8