

REV	DESCRIPTION	DATE
A/0	原始版本	E
A/1	修订版本	

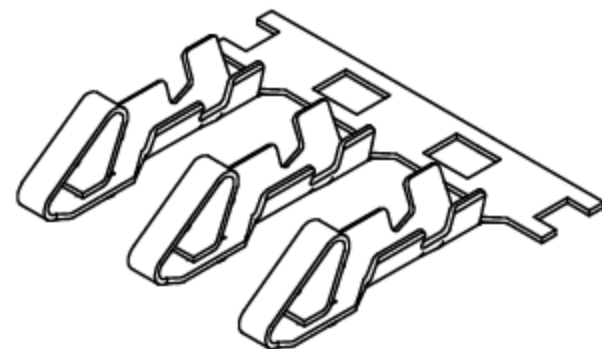
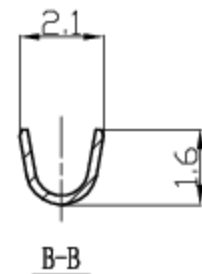
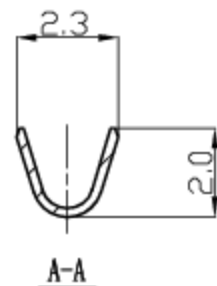
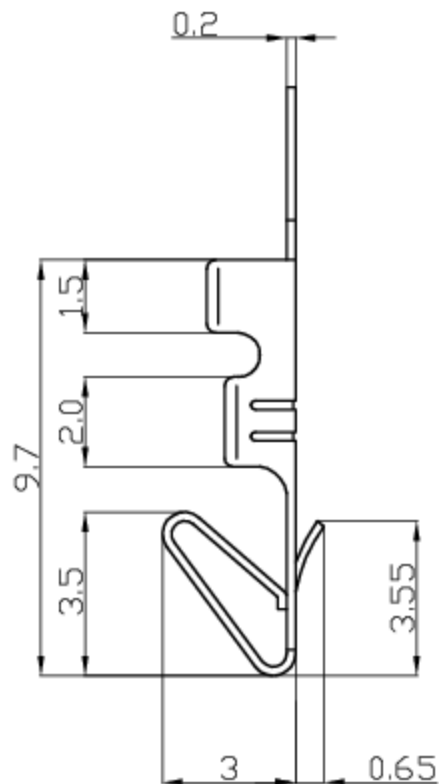
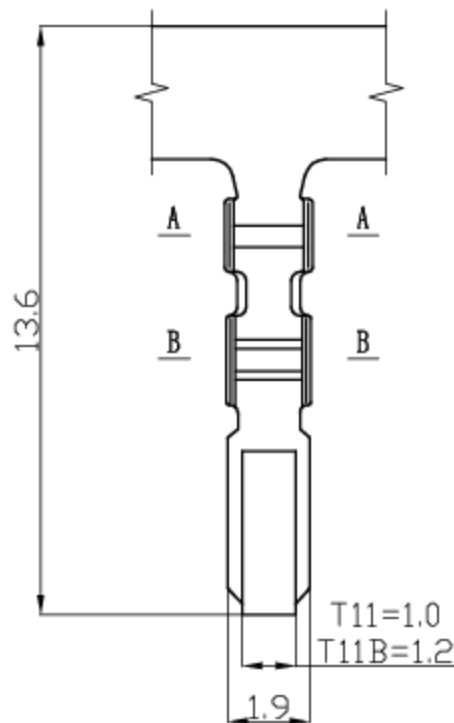

**主要技术参数**  
**Main Specifications**

线数 (poles): 2 to 16P  
 额定电流 (Current rating): 4.0A AC, DC  
 额定电压 (Voltage rating): 250V AC, DC  
 温度范围 (Temperature range): -25°C to +85°C  
 接触电阻 (Contact resistance):  $\leq 10\text{m}\Omega$   
 绝缘电阻 (Insulation resistance):  $\geq 1000\text{m}\Omega$   
 耐电压 (Withstand voltage): 1000V AC/minute  
 适用线规 (Applicable wire): AWG #28 to #22  
 适用基板厚度 (Applicable PC board thickness): 1.6mm

1	SNA2543-TP2	Phos Bronze tin 磷青铜镀锡	10000PCS/Roll (1盘)						
序号	料号	材料	附注						
未注公差									
X. <sup>o</sup> ±3° X.X <sup>o</sup> ±0.5°									
>0-3	>3-18	>18-50	>50-120	单位	比例	Design Units	SIZE	页码	
±0.12	±0.15	±0.3	±0.5	MM Only	—	METRIC	A4		
制作	审核	批准	材料	图号			Part No		
				见图解	品名				