

OST08WG01GD-XXXXXXXXXX

Flat

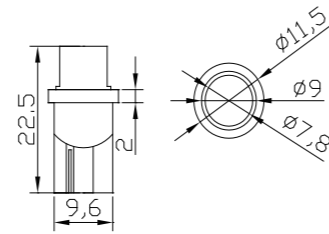

T8 Flat	Part Number
white	W5YKT8E1A
yellow	Y5RUT8E1A
red	R5RUT8E1A
green	G5DUT8E1A
blue	B5YUT8E1A



Round



T8 Round	Part Number
white	W5YKT831A
yellow	Y5RUT831A
red	R5RUT831A
green	G5DUT831A
blue	B5YUT831A

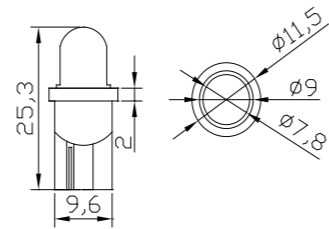

Concave



T8 Concave	Part Number
white	W5YKT8C1A
yellow	Y5RUT8C1A
red	R5RUT8C1A
green	G5DUT8C1A
blue	B5YUT8C1A

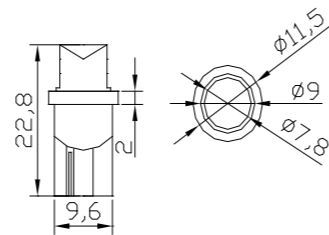

Automotive LED T8 Series

- ◆ Dashboard Light
- ◆ Width-indicator Lamp
- ◆ Signal Light



Applications:



Absolute Maximum Ratings (Ta=25°C)

Items	Symbol	Values	Units
Operating Supply Range (DC)	V _{dc}	16	V
Input Current (DC)	I _i	30	mA
Power Dissipation	P _a	0.48	W
Operating Temperature	T _{op}	-10 ~ +40	DegC
Storage Temperature	T _{sto}	-20 ~ +80	DegC

Typical Performance (Ta=25°C)

Items	Symbol	Min	Typ	Max	Units
LED Module Power	P _m	-	0.24	0.48	W
Input Voltage (DC)	V _i	-	12	16	V
Product Input Current	I _f	-	20	30	mA
Beam Pattern	BP	-	-	-	Deg
Total Diameter of PCB	L _{mod.}	-	25.3	-	mm
Net Weight	W _{ei.}	---	1.2	---	g