

立式

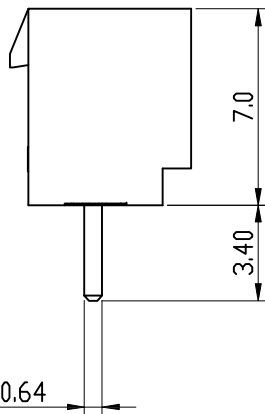

卧式

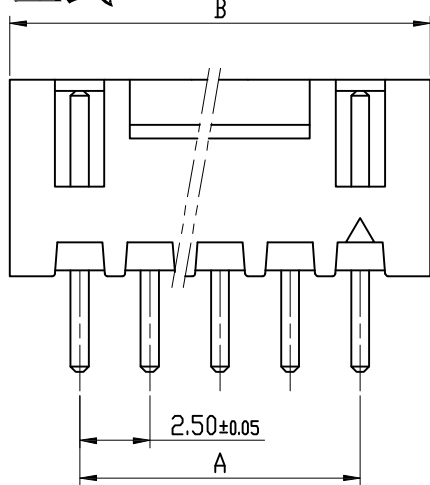
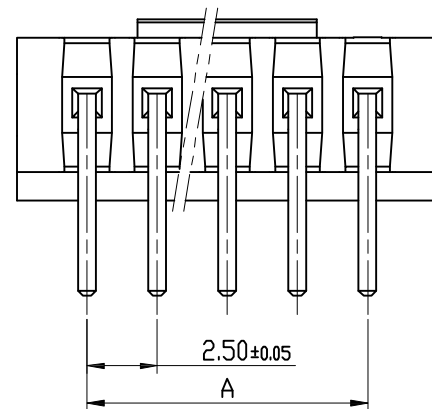
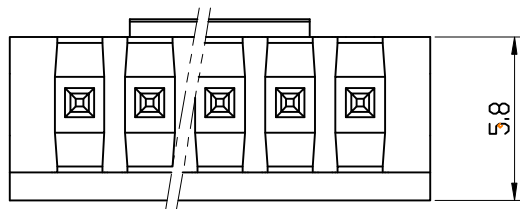
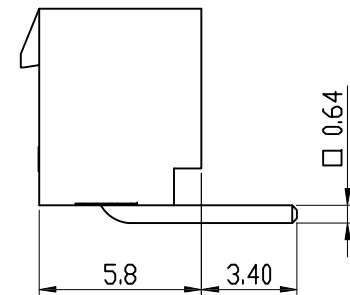
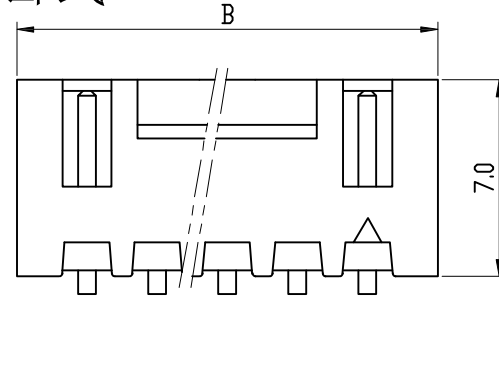

■ SPECIFICATION

- Voltage rating: 250V AC, DC
- Current Rating: 3.0A, AC, DC
- Withstand voltage: 1000V AC/minute
- Contact resistance: 20mΩ max
- Temperature range: -25° C ~ +85° C
- Insulation resistance: 1000MΩ min

■ WAFER

- Material: Base: Nylon 66 UL94V-0  
pin: Brass Tin-plated

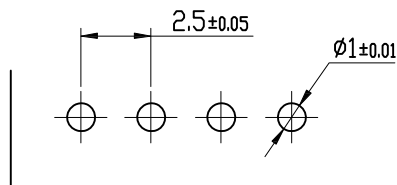

P. C. B LAYOUT

Poles	DIM		Poles	DIM	
	A	B		A	B
2	2.50	7.50	11	25.00	30.00
3	5.00	10.00	12	27.50	32.50
4	7.50	12.50	13	30.00	35.00
5	10.00	15.00	14	32.50	37.50
6	12.50	17.50	15	35.00	40.00
7	15.00	20.00	16	37.50	42.50
8	17.50	22.50	--	--	--
9	20.00	25.00	20	47.50	52.50
10	22.50	27.50			

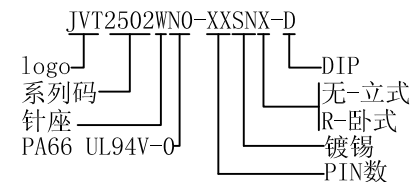

GENERAL TOLERANCE	
0	±0.35
.0	±0.30
.00	±0.20
.000	±0.10



核准	审核	绘图	品名	XHB2.5mm WAFER		
	bolly	TONY	料号	JVT2502WNO-XXSNX-D		
			图名	041	版本	A

版本	变更内容	日期	单位	mm	比例	1:1	日期	20130507
----	------	----	----	----	----	-----	----	----------

A B C D E F G H